



DESCRIPTION

The BAS516 is available in SOD-523 Package.

FEATURES

- Extremely small surface mounting type.
- Small package.
- High speed and high reliability

ORDERING INFORMATION

Package Type	Part Number
SOD-523	BAS516
Note	3,000pcs/Reel
AiT provides all RoHS Compliant Products	

PIN DESCRIPTION

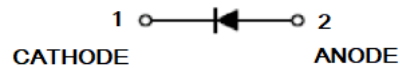

ABSOLUTE MAXIMUM RATINGS

$T_A = 25^\circ\text{C}$

V_{RRM} , Repetitive Peak Reverse Voltage	90V
V_R , Continuous Reverse Voltage	80V
I_F , Continuous Forward Current (Double Diode Loaded)	225mA
I_{FSM} , Surge current	0.5A
P_D , Total power dissipation	150mW
T_J , Junction Temperature	125°C
T_{STG} , Storage Temperature Range	-55°C ~+125°C

Stresses above may cause permanent damage to the device. These are stress ratings only and functional operation of the device at these or any other conditions beyond those indicated in the Electrical Characteristics are not implied. Exposure to absolute maximum rating conditions for extended periods may affect device reliability.



ELECTRICAL CHARACTERISTICS

T_A = 25°C, unless otherwise noted

Parameter	Symbol	Conditions	Min	Typ.	Max	Unit
Forward Voltage	V _F	I _F = 100mA	-		1.2	V
Reverse Current	I _R	V _R = 80V	-		20	μA
Diode Capacitance	C _D	V _R = 0.5V, f = 1MHz	-	0.72	3.0	pF
Reverse Recovery Time	t _{rr}	V _R =6V, I _F =10mA, R _L =100Ω	-		4	ns

TYPICAL CHARACTERISTICS

T_A = 25°C

Figure 1. Forward Characteristics

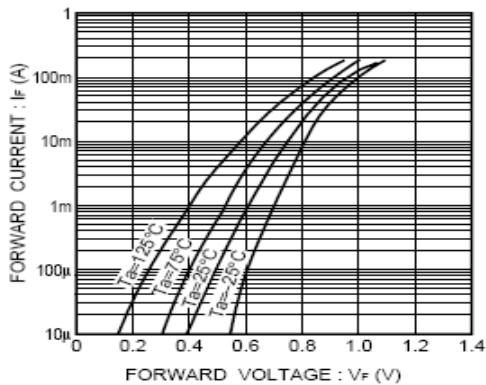

Figure 2. Reverse Characteristics

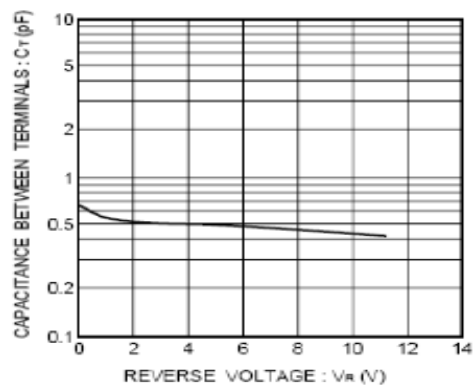
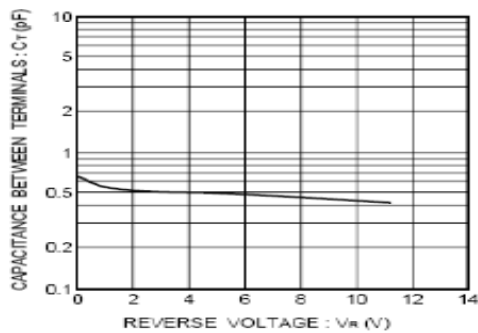

Figure 3. Capacitance between terminals





PACKAGE INFORMATION

Dimension in SOD-523 Package (Unit: mm)

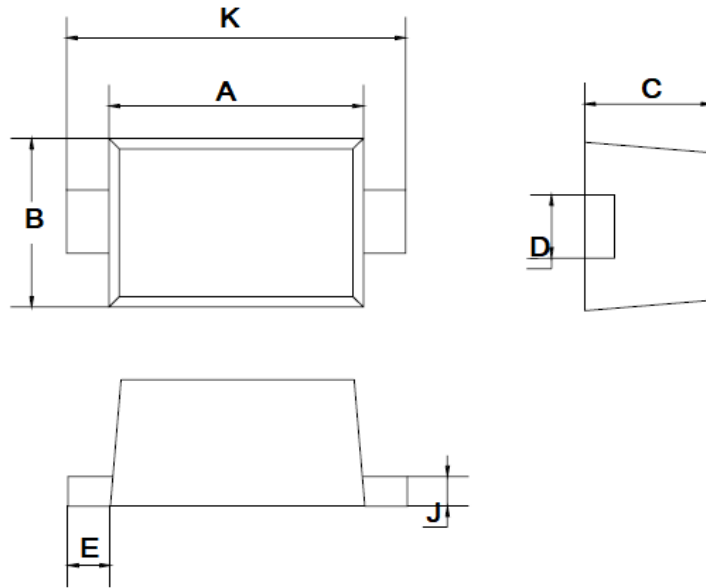

UNIT	SOD-523	
	MIN	MAX
A	1.10	1.30
B	0.70	0.90
C	0.50	0.70
D	0.25	0.35
E	0.15	0.25
J	0.1 (Typ)	
K	1.50	1.70



IMPORTANT NOTICE

AiT Components (AiT) reserves the right to make changes to any its product, specifications, to discontinue any integrated circuit product or service without notice, and advises its customers to obtain the latest version of relevant information to verify, before placing orders, that the information being relied on is current.

AiT Components' integrated circuit products are not designed, intended, authorized, or warranted to be suitable for use in life support applications, devices or systems or other critical applications. Use of AiT products in such applications is understood to be fully at the risk of the customer. As used herein may involve potential risks of death, personal injury, or severe property, or environmental damage. In order to minimize risks associated with the customer's applications, the customer should provide adequate design and operating safeguards.

AiT Components assumes no liability to customer product design or application support. AiT warrants the performance of its products of the specifications applicable at the time of sale.